

SCH 30



62 lb Self-contained Ice Machine

Technical features

- Stainless steel bodywork
- Vertical pump
- Built-in cleaning system
- Easily accessible components
- Low power and water consumption
- Optimum ratio between ice production and bin capacity
- Reduced dimensions
- Double defrosting system
- Electronic PCB to create perfect cubes and help troubleshooting with alarm signals
- Scale Tap
- Bin Sensor Thermic
- Easy Clean Spray system
- R290 Condenser



Internal bin capacity



18.7 lb of ice
430 cubes

Type of ice

Full Cubes

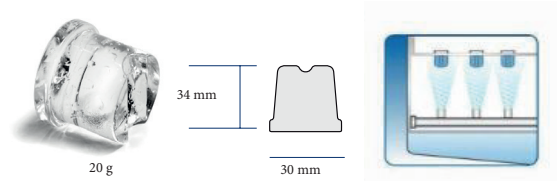

Voltage

115/60/1 Standard version

Machine dimensions

Exterior dimensions WxDxH	15.2x20.2x29.5 in
Product Weight	68.4 lb
Shipping Dimensions	18.1x22.8x29.9 in
Shipping Weight (approx.)	81.6 lb

Technology and Certifications



FOOD SERVICE SOLUTIONS INC.
1-430 Industrial Drive
Milton, ON
L9T 5A6
(800) 668-8765
e-mail:
info@FoodServiceSolutions.com



SCH 30

SIMAG
by Scotsman

62 lb Self-contained Ice Machine

Accessories

- Scoop
- Hose set tubes
- Drain tube
- Legs
- Floor mount kit to be provided with the unit to be ordered as accessory (SCKITFLOORSCH30)

Warranty

- 3 years parts and labor costs
- 5 years warranty on compressor



SCH 30



62 lb Self-contained Ice Machine

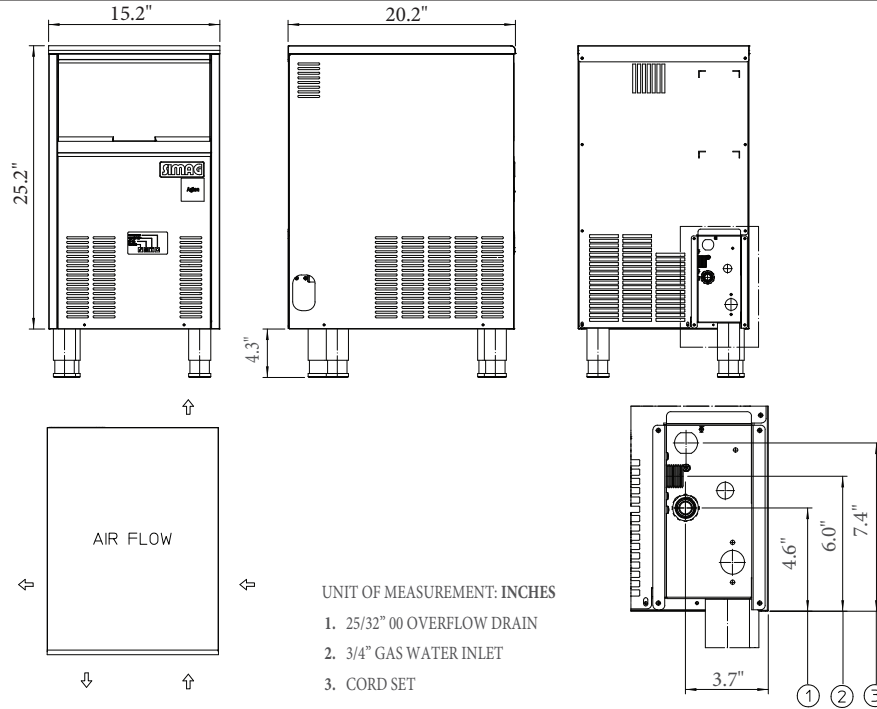

DRAINAGE PER GRAVITY

Operating Limits

	Minimum	Maximum
Ambient temperature	50°F (10°C)	100°F (38°C)
Water temperature	40°F (5°C)	100°F (38°C)
Water pressure	1 bar (14 PSI)	5 bar (70 PSI)
Clearance (right and left)	6 in (15 cm)	-

Specifications and design are subject to change without notice
 Note: if clearance is less, ice production will decrease up to 20/25%

Model	Voltage	Daily production lb		Daily production kg		Power input Watt (*)	Refrigerant	Fuse A	Consumptions (**)			
		21/10°C 70/50°F	32/21°C 90/70°F	21/10°C 70/50°F	32/21°C 90/70°F				kJ/kg	kWh/100lb	l/kg	Water gal/100lb
SCH 30 A	115/60/1	62	45	28	20.5	360	R290	10	1300	16.38	3.3	40

(*) Power Input: at 90°F Ambient Temperature
 (***) Water Consumption: at 90°F Air and 70°F Water